

# Pro/ENGINEER Wildfire 4.0 Update from Pro/ENGINEER Wildfire 2.0

## Overview

Course Code TRN-2172-T

Course Length 2 Days

In this course, you will learn how to utilize many of the enhancements to core functionality in Pro/ENGINEER Wildfire 4.0. This course is intended as an update directly from Pro/ENGINEER Wildfire 2.0 to Pro/ENGINEER Wildfire 4.0, so some of the enhancements covered in this course were introduced in the Pro/ENGINEER Wildfire 3.0 release. You will become familiar with enhancements to Part mode, including embedded datum creation, and warp and partial shell features. You will learn new methods for creating features such as swept blends, and new methods for placing user defined features. You review new capabilities for feature manipulation, such as enhanced patterning capabilities. You will become familiar with the enhancements to Sketcher, such as how to copy and paste items in sketcher and how to insert predefined shapes such as polygons and common engineering sections, such as I-beams. You will also learn how to reference intent objects and replace sketcher references. You will learn about new and enhanced Assembly capabilities such as the Global Reference Manager and the new user interface for assembling components. You will use new drawing functionality, including how to create shaded drawing views. You will also learn about sheetmetal enhancements including how to create multiple walls in a single operation.

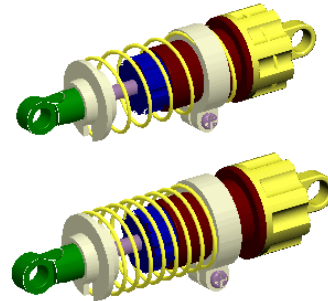

## Course Objectives

- Describe and utilize Part enhancements.
- Describe and utilize Sketcher enhancements.
- Describe and utilize Assembly enhancements.
- Describe and utilize Drawing enhancements.
- Describe and utilize Sheetmetal enhancements.

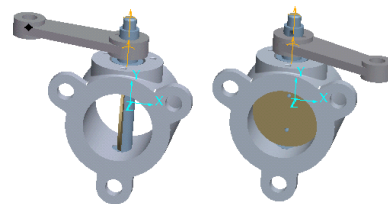

## Prerequisites

---

- Completion of T1707-340 Pro/ENGINEER Wildfire 2.0 Update or equivalent experience.

## Audience

---

- This course is intended for people who have already upgraded to Pro/ENGINEER Wildfire 2.0, and who are moving directly to Pro/ENGINEER Wildfire 4.0.
-

# Agenda

## Day 1

---

Module 1 Part Enhancements

Module 2 Part Feature Duplication Enhancements

Module 3 Sketcher Enhancements

## Day 2

---

Module 4 Assembly Component Enhancements

Module 5 Advanced Assembly Enhancements

Module 6 Drawing Enhancements

Module 7 Sheetmetal Enhancements

---